



Cultural Heritage Agency
Ministry of Education, Culture and Science

Finding the optimum museum storage

*What can be learned from an evaluation
in the Netherlands*

Bart Ankersmit

Klima og museumssamlinar i møte med økonomiske utfordringer
Bergen, Norway
24-25 april 2023



Rijksmuseum - 1905



Rijksmuseum - 1974



1950



1975



1996



Off site storage 2002

Purpose built storages in the Netherlands

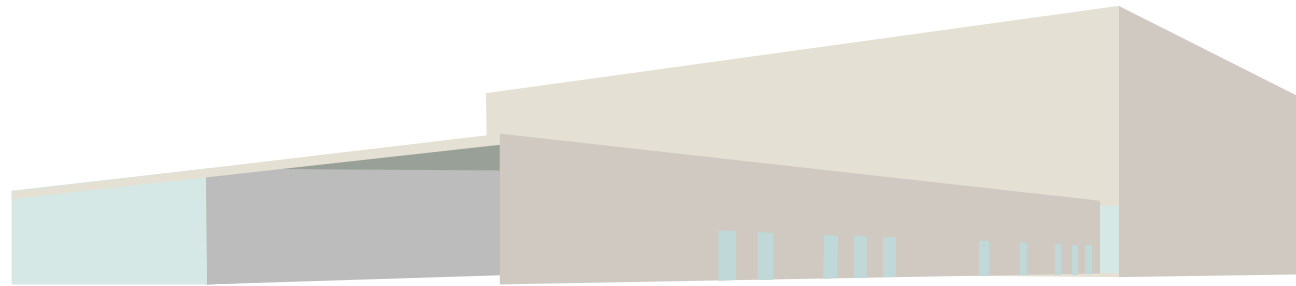
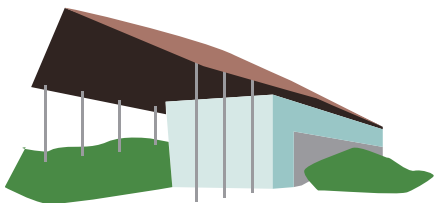
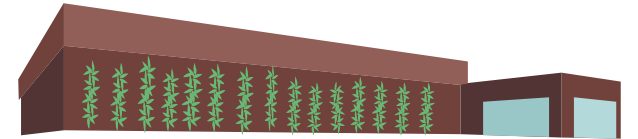
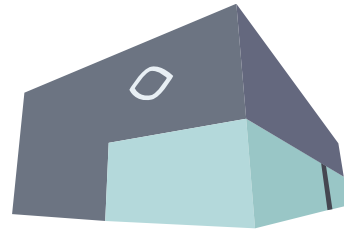
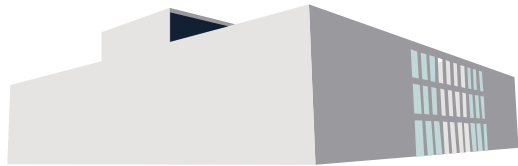
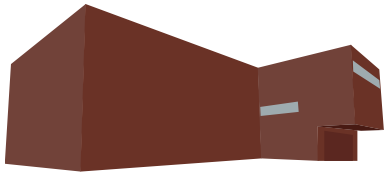
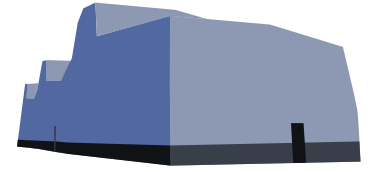
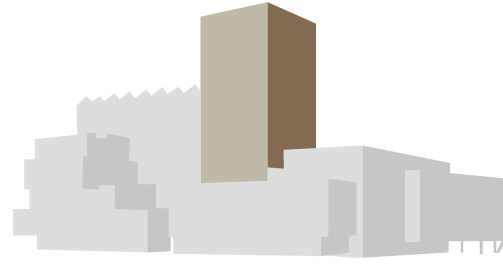
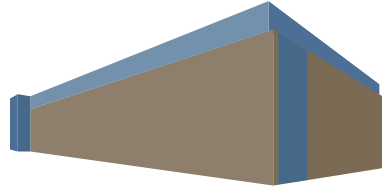
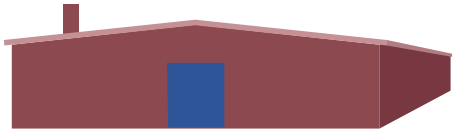

2001

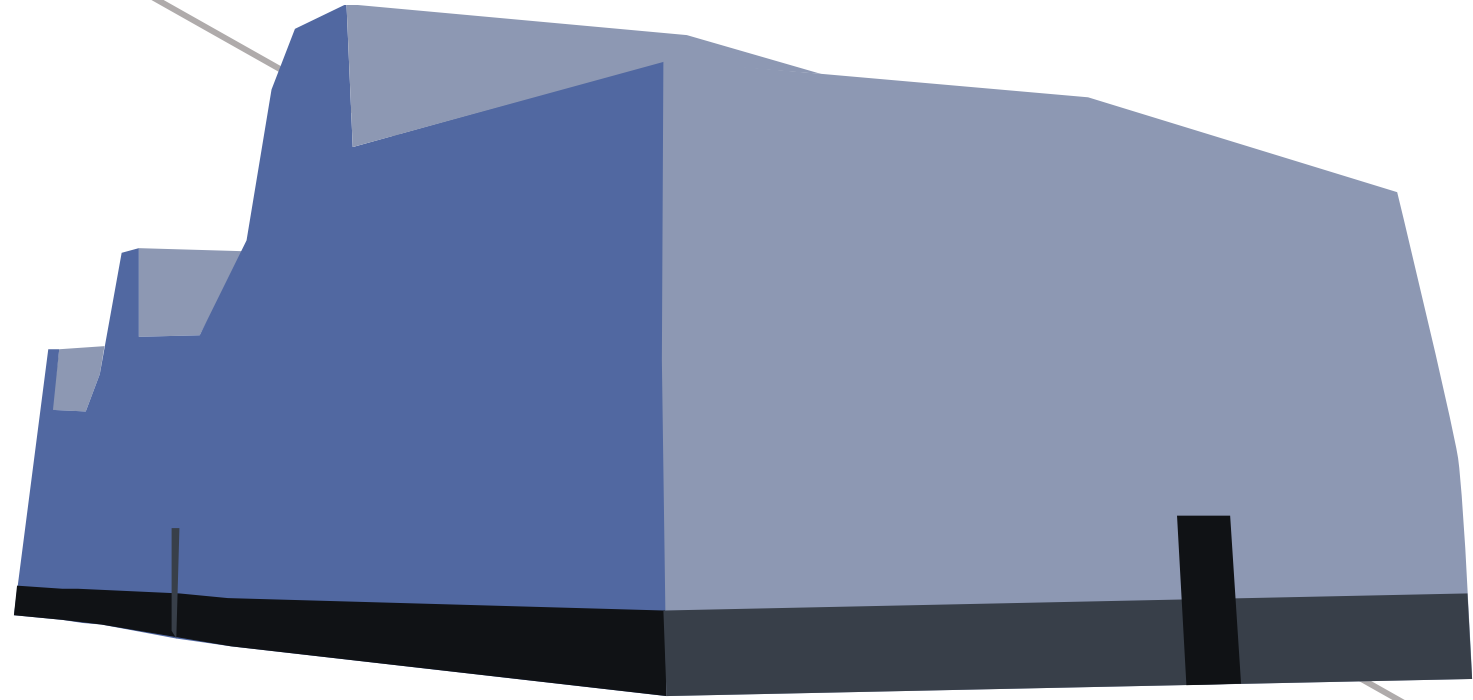

Maritime Museum Amsterdam



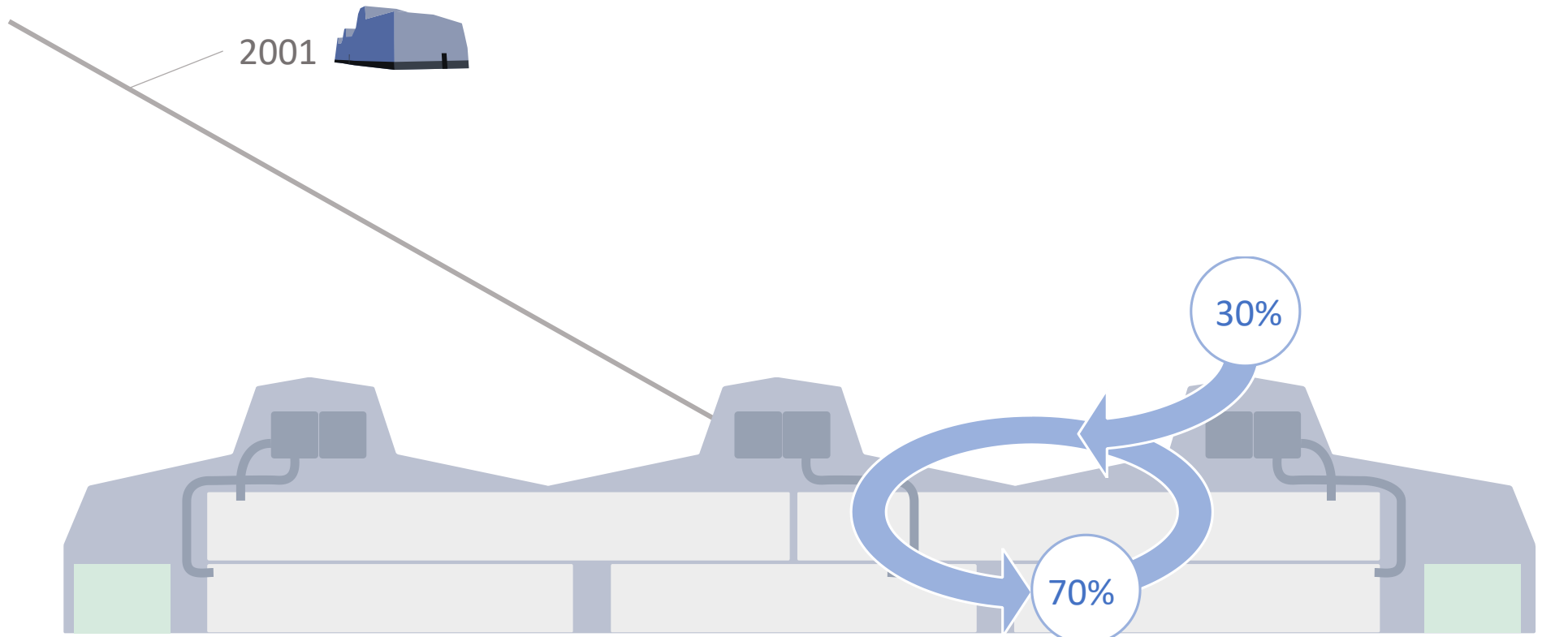

2001



30%

70%

$18^{\circ}\text{C} < T < 22^{\circ}\text{C} (\pm 2^{\circ}\text{C})$
RH = $50\% \pm 5\%$ (\rightarrow now $55\% \pm 2\%$)



2001



2009



2010

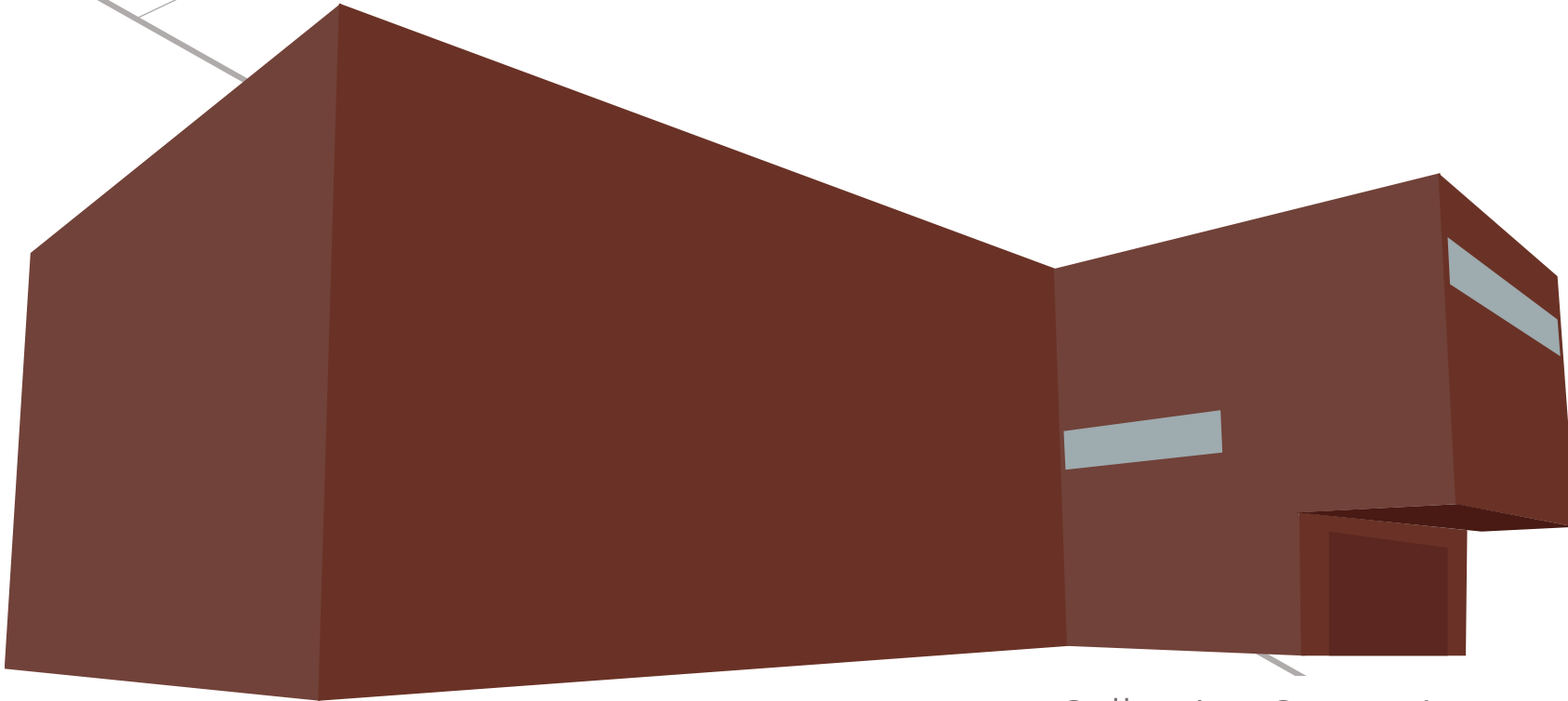

Collection Center Amsterdam

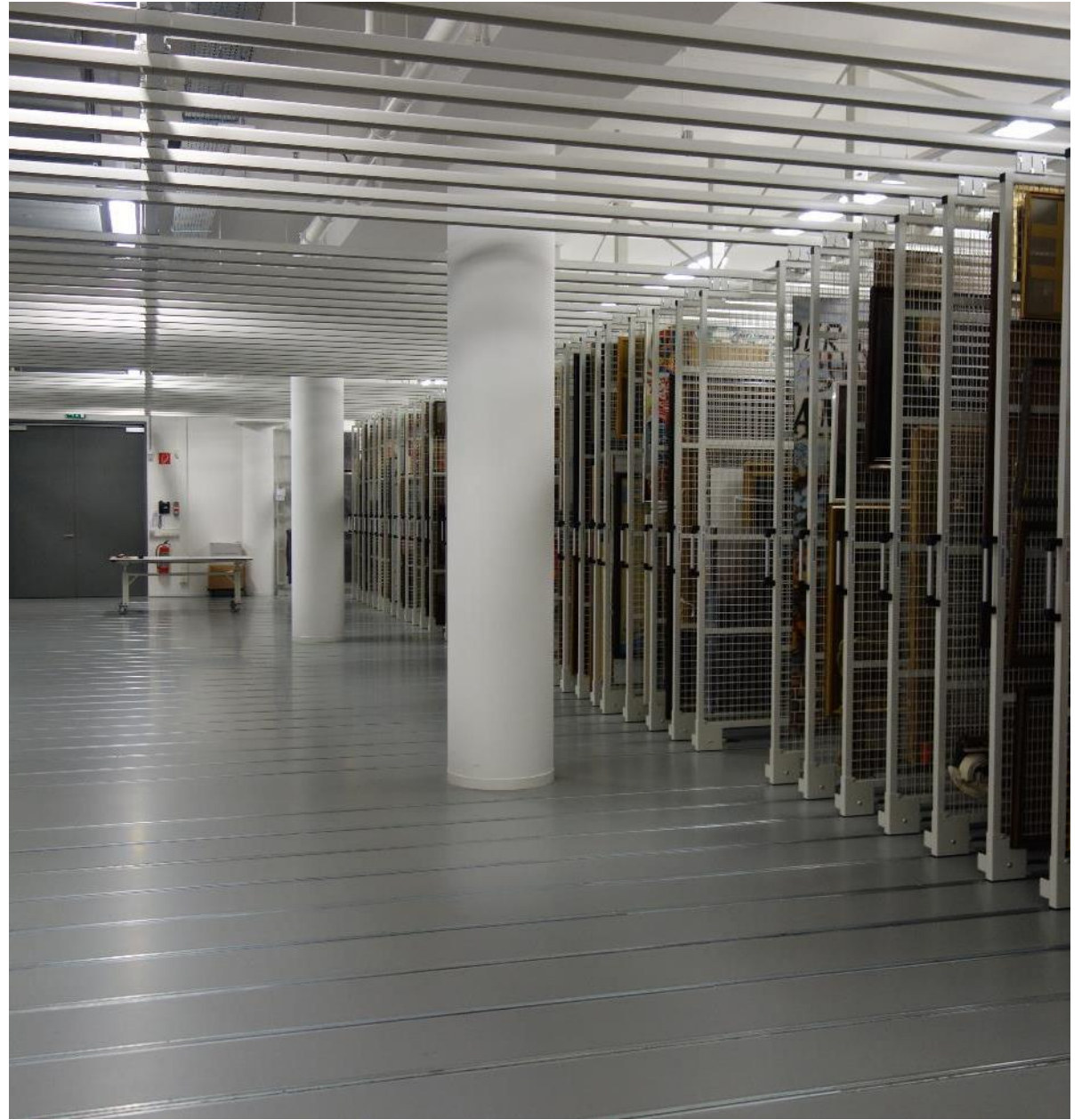

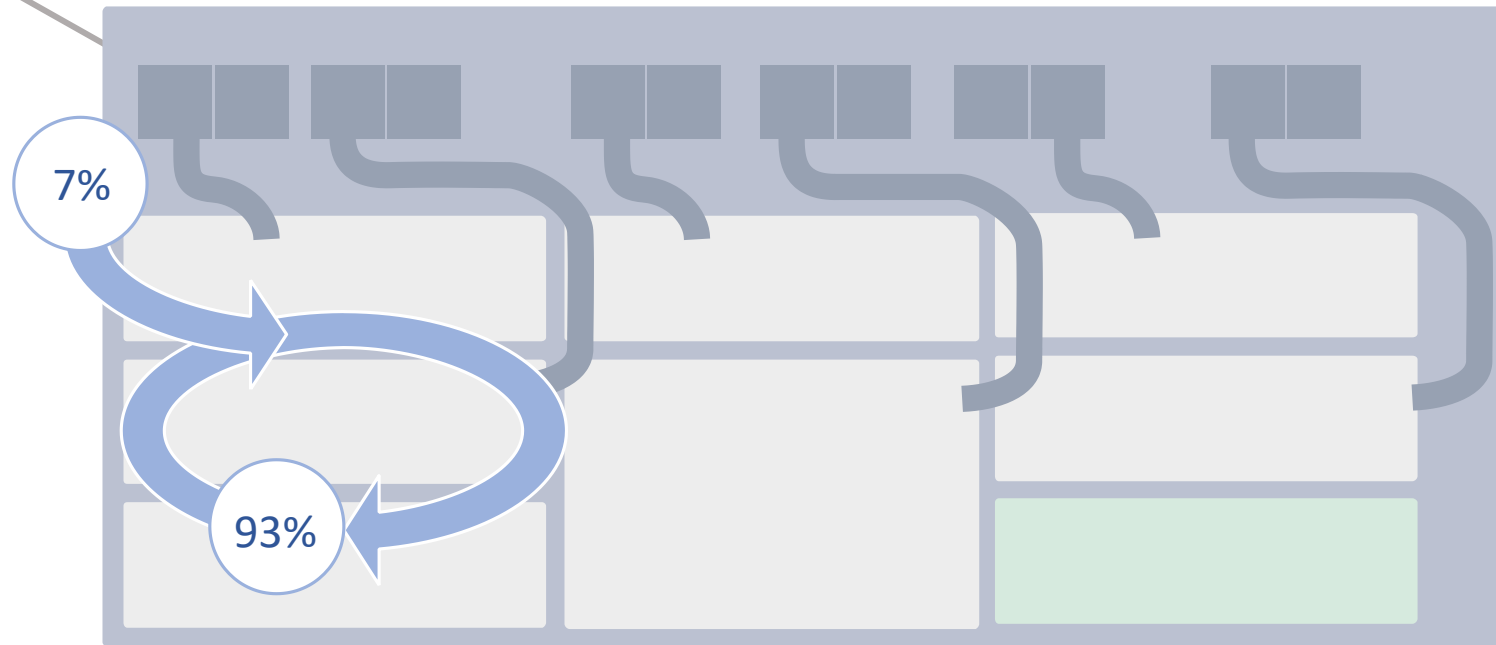
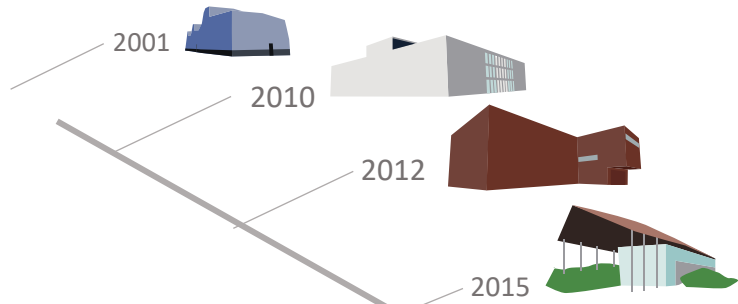

$18^{\circ}\text{C} \pm 1^{\circ}\text{C} < T < 22^{\circ}\text{C} \pm 1^{\circ}\text{C}$
 $48\% \pm 3\% < \text{RH} < 52\% \pm 3\%$

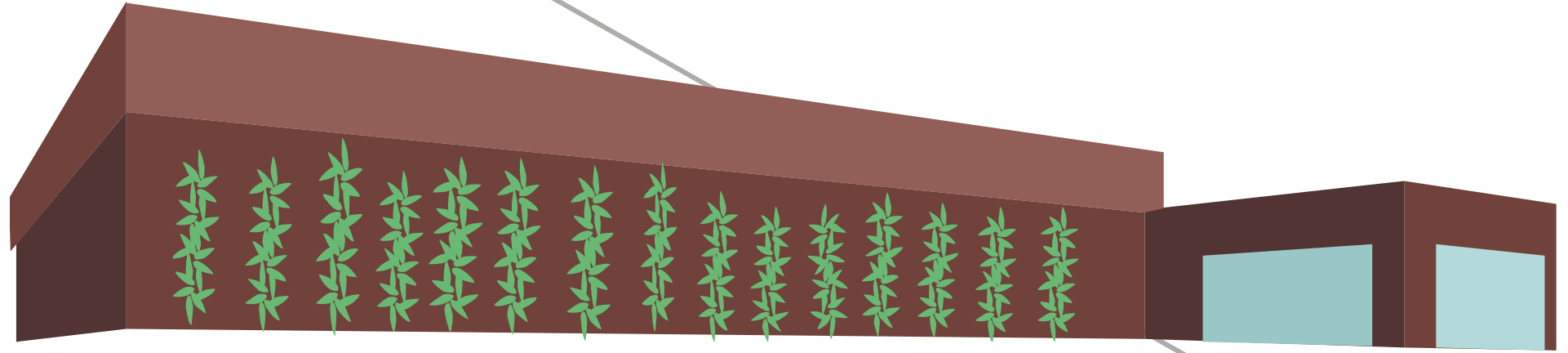
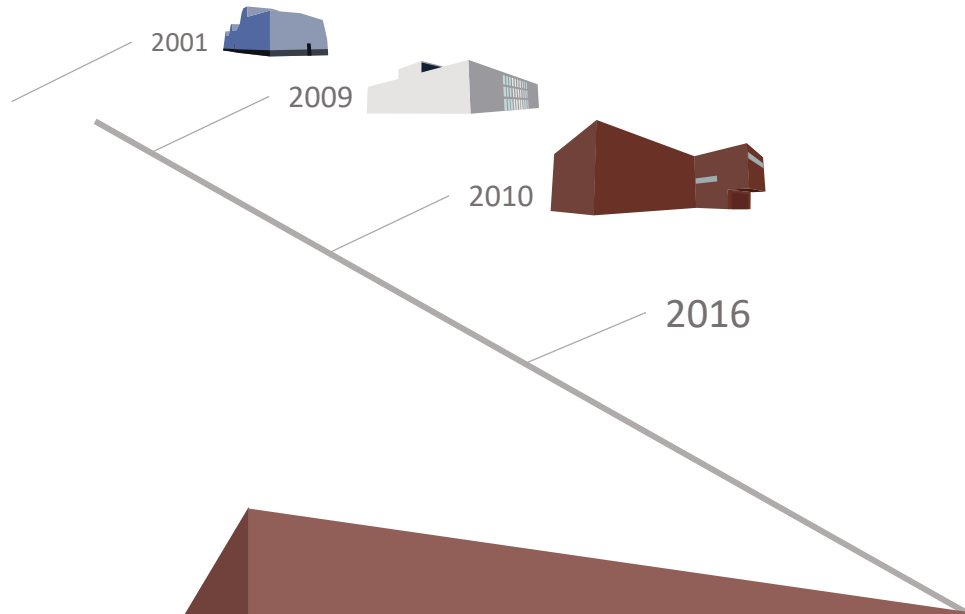

Collection Center Leeuwarden

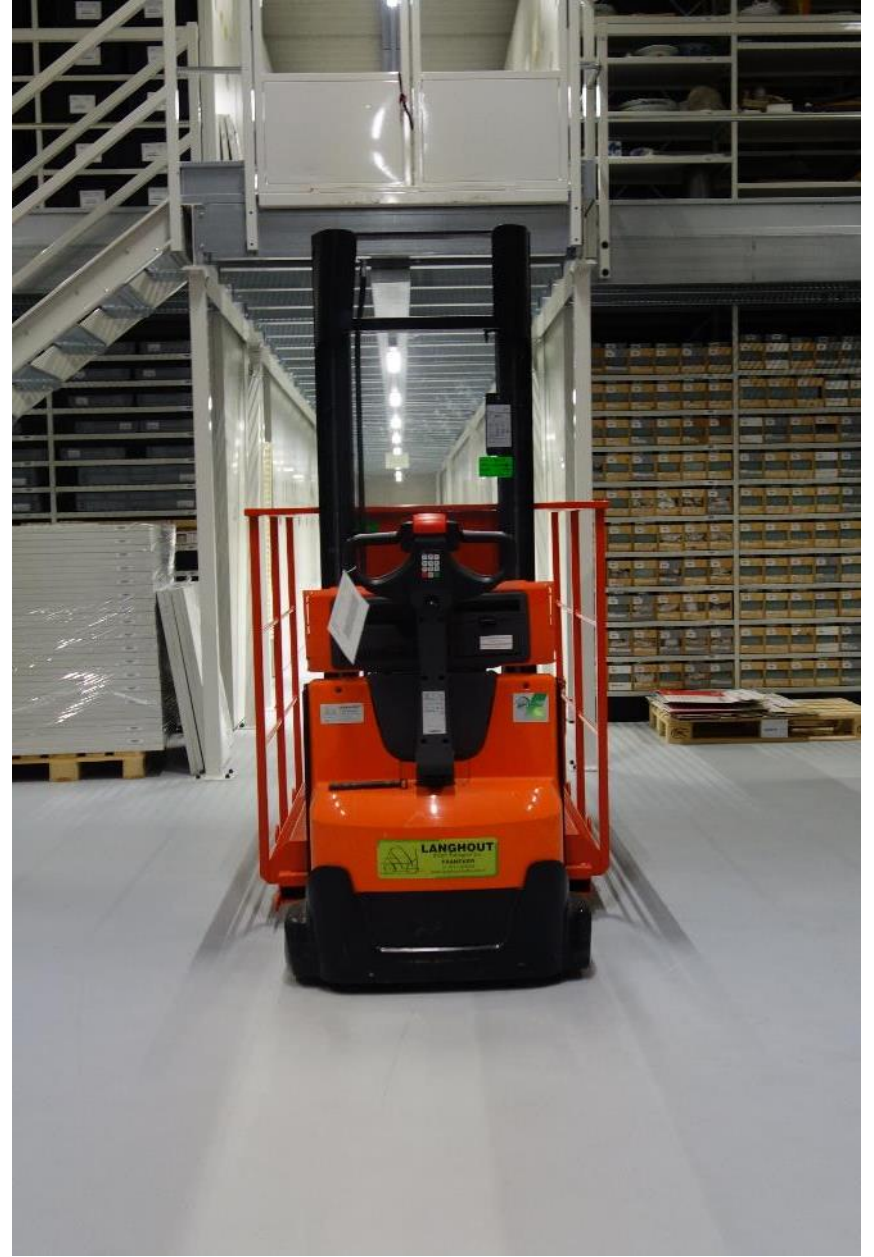

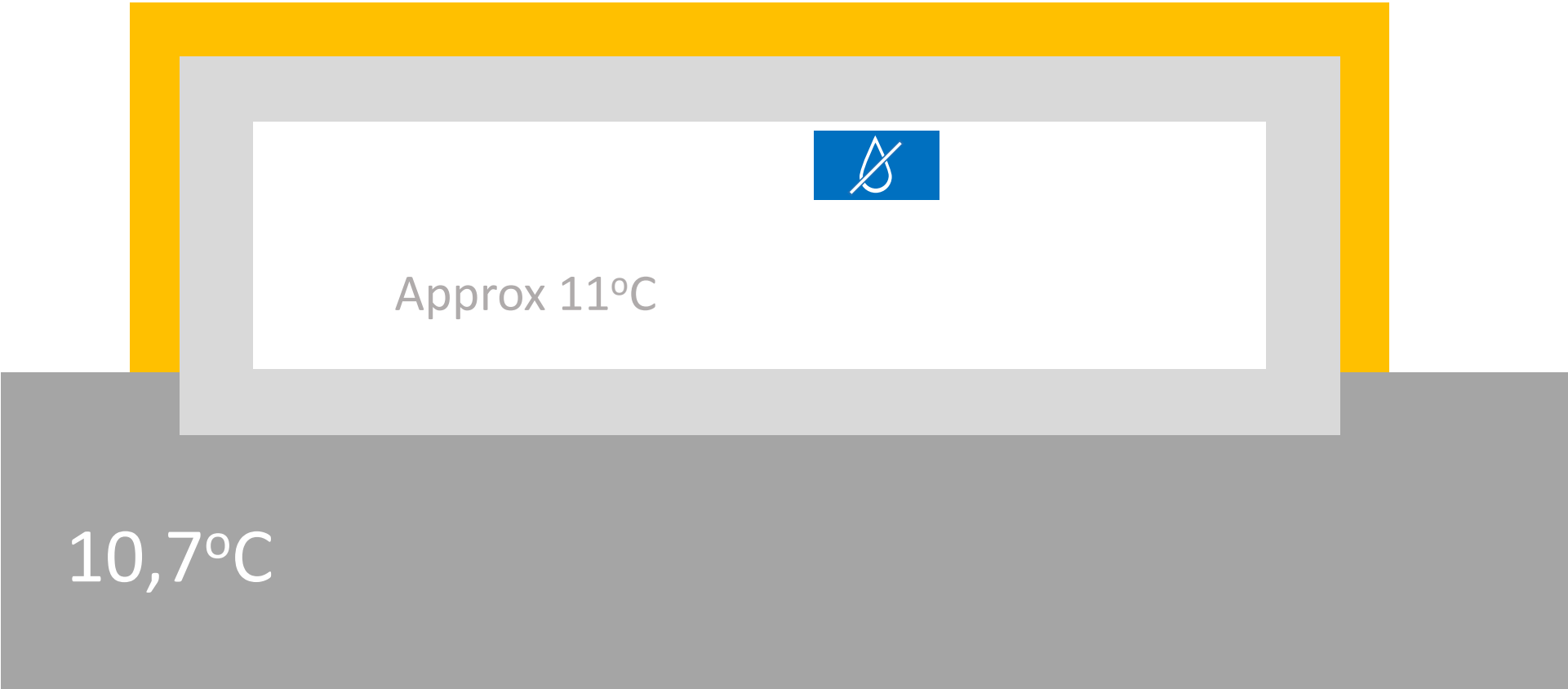

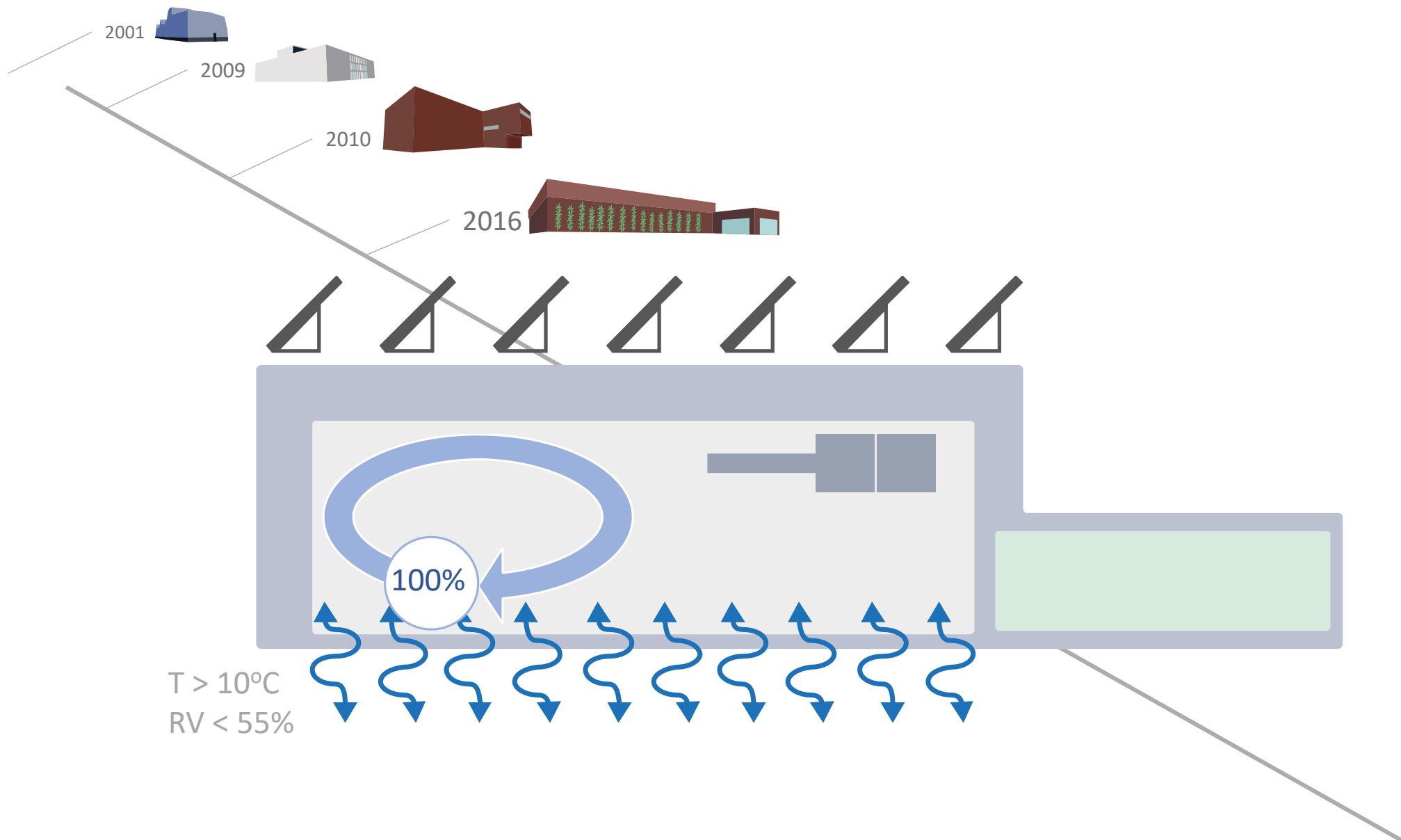

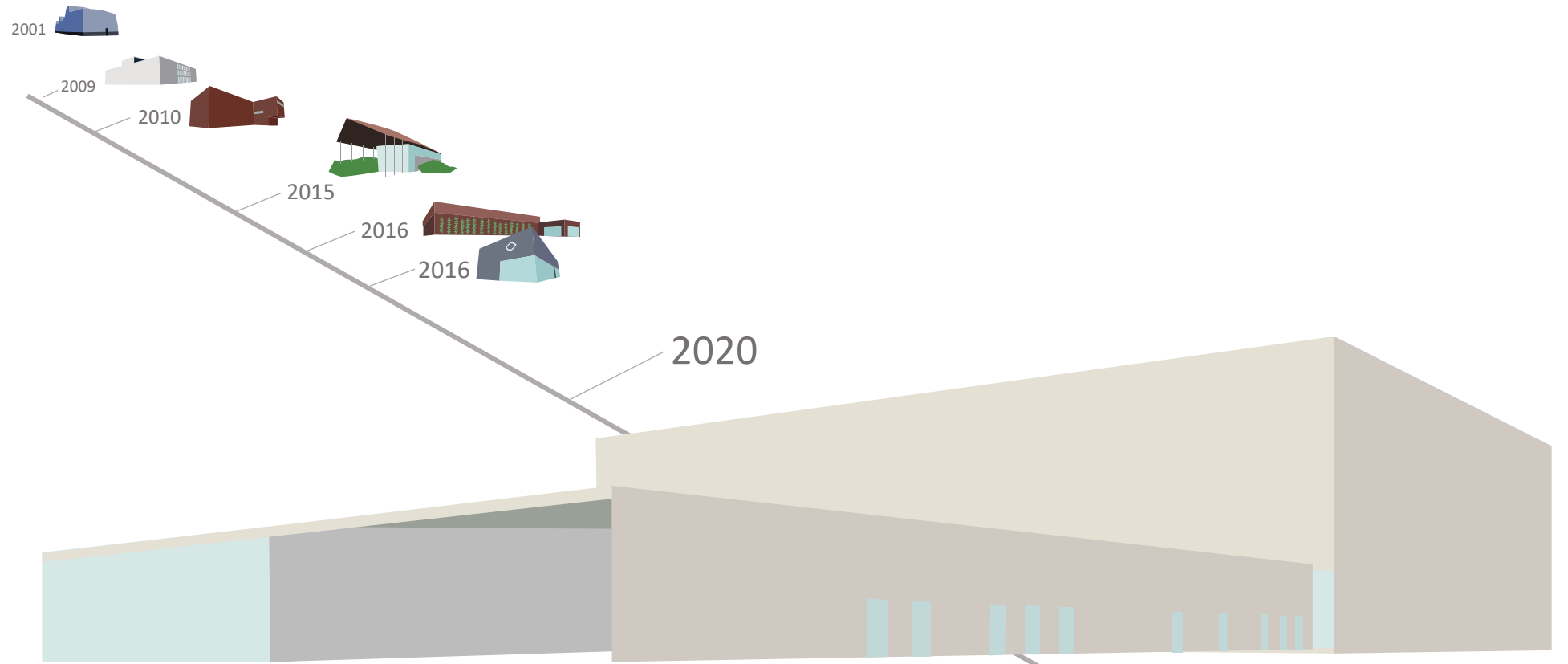

CC-NL Amersfoort



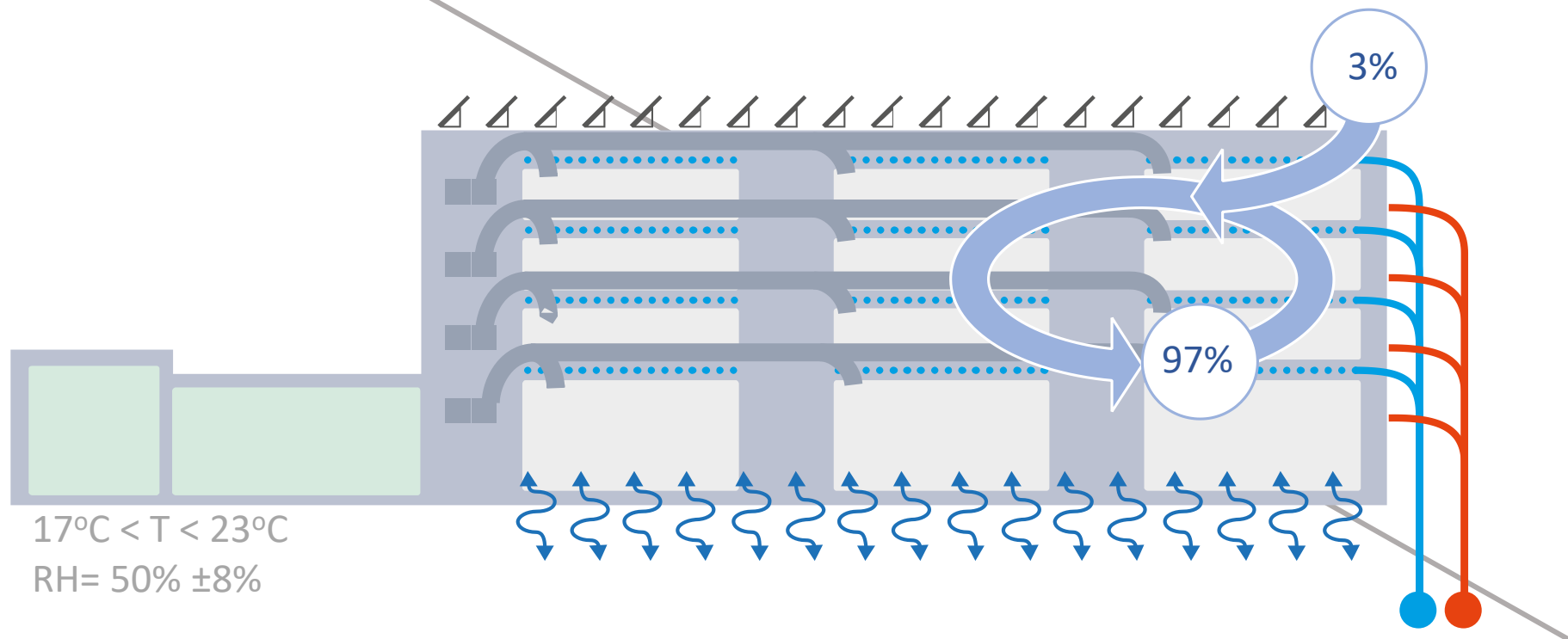
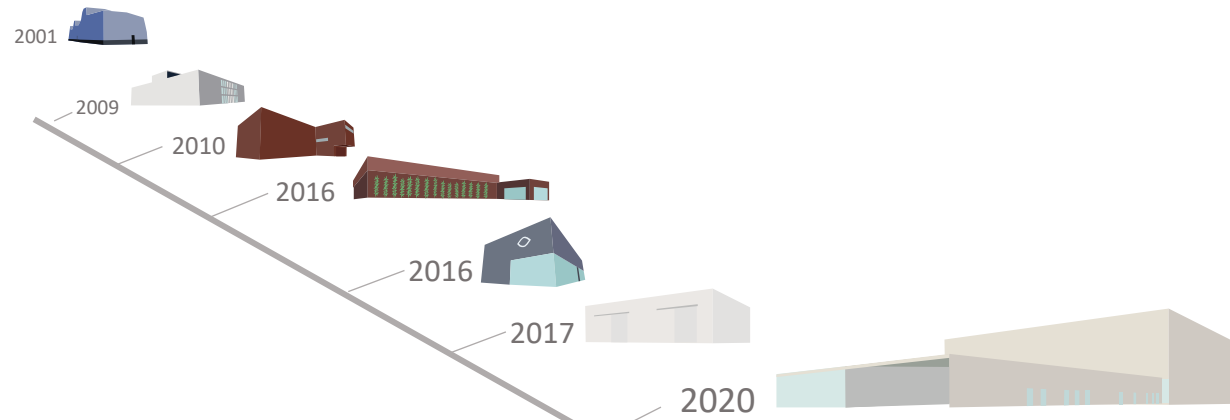

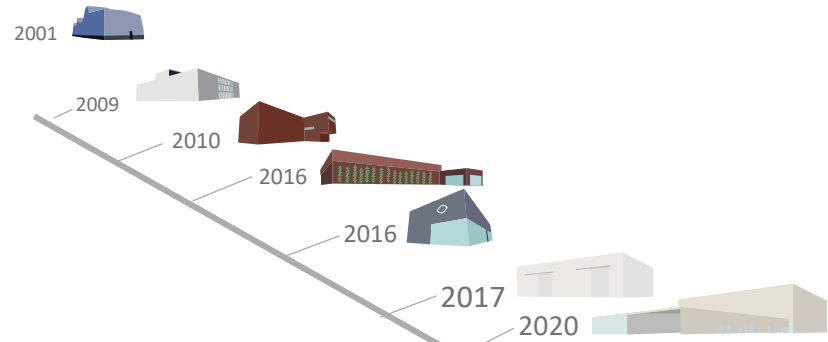

Storage Boijmans van Beuningen Rotterdam

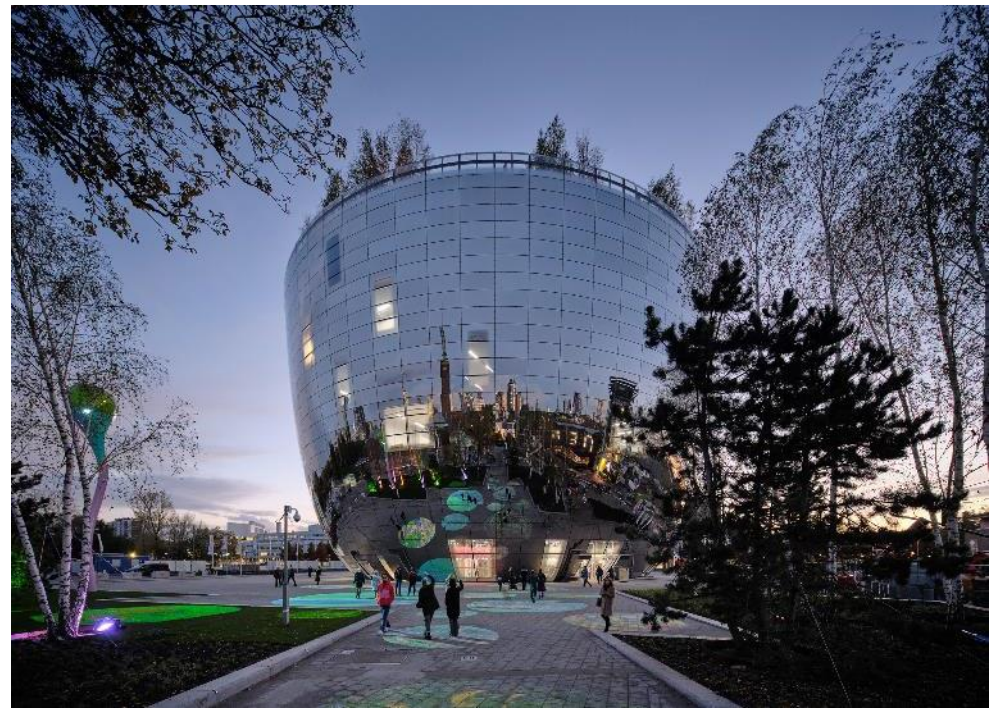

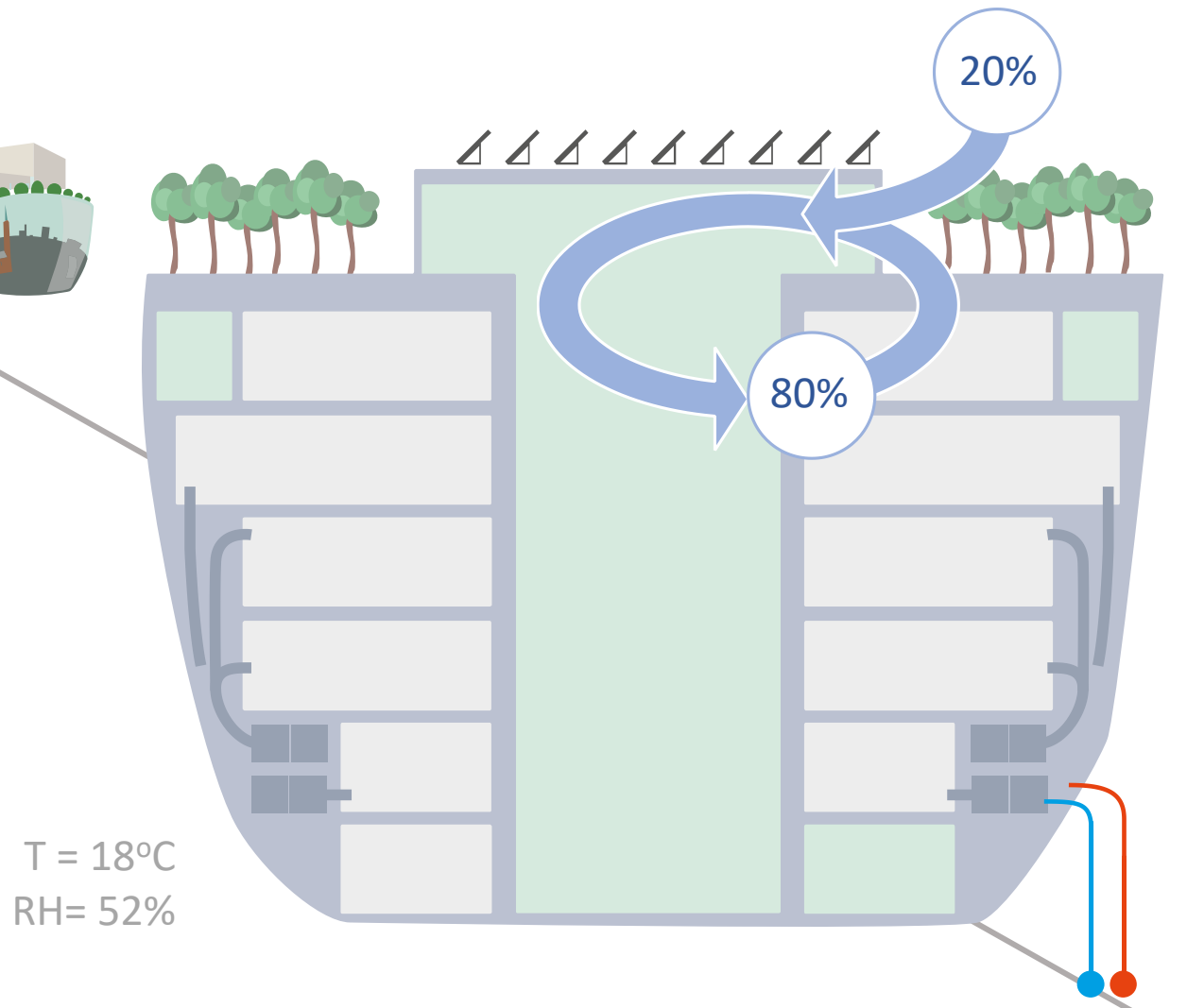
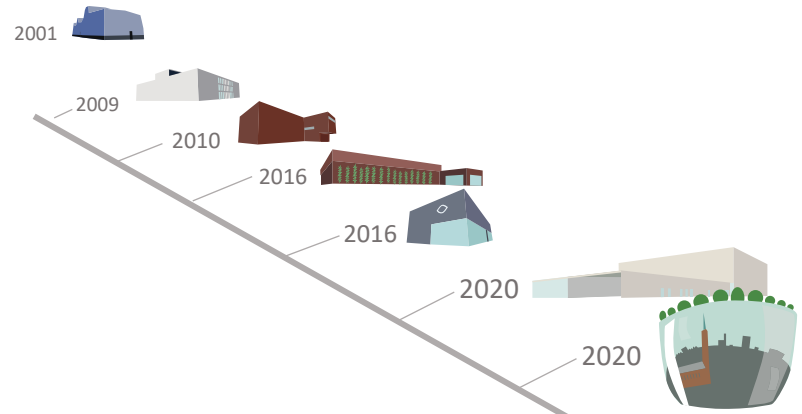

How can we evaluate these buildings?

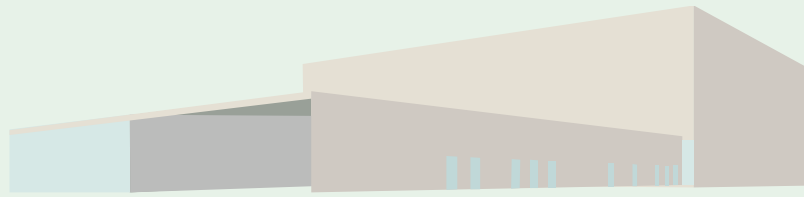

→ Access

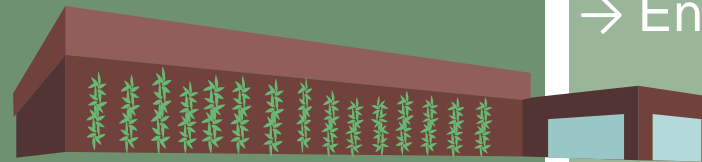
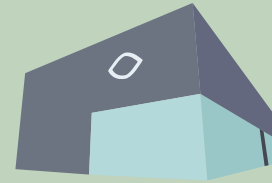
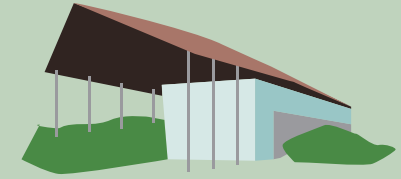

→ Energy



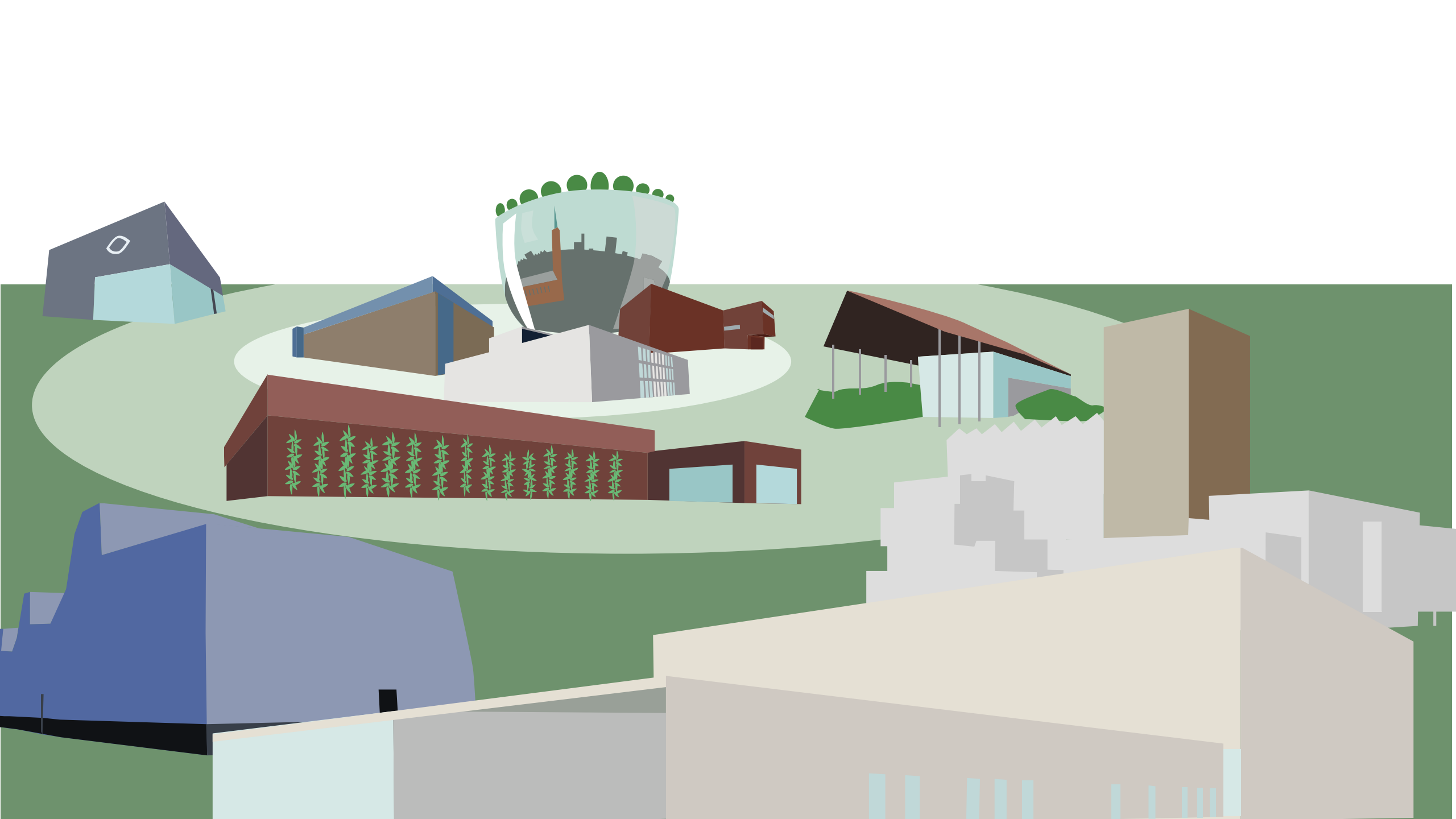

Are there any trends?

Thermal insulation

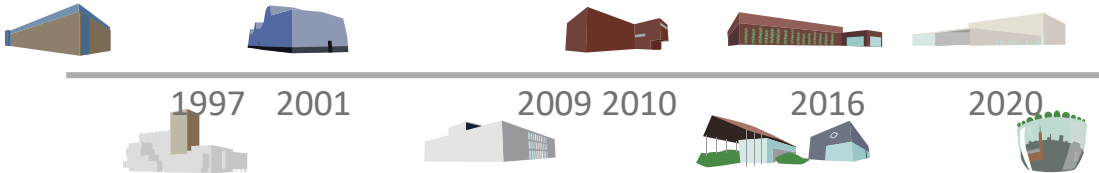
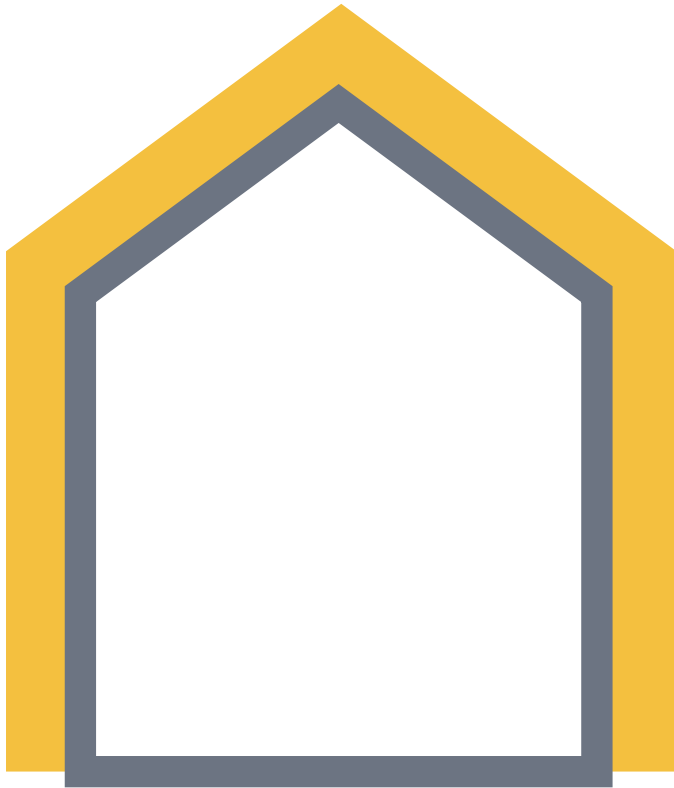
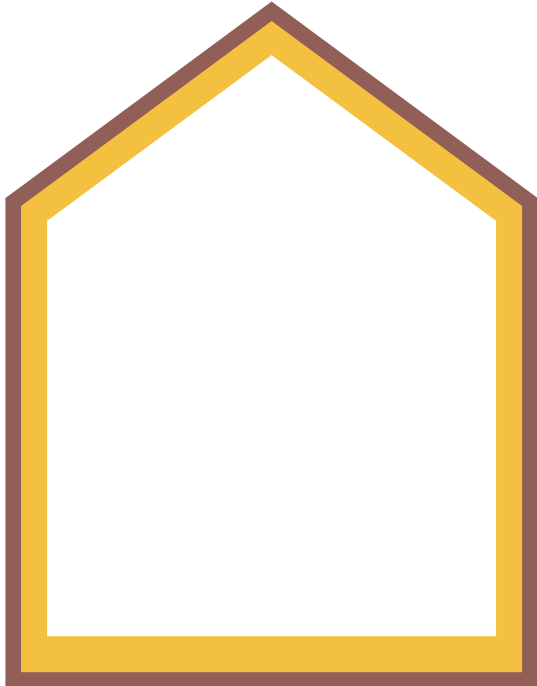



oil temperature in the Netherlands

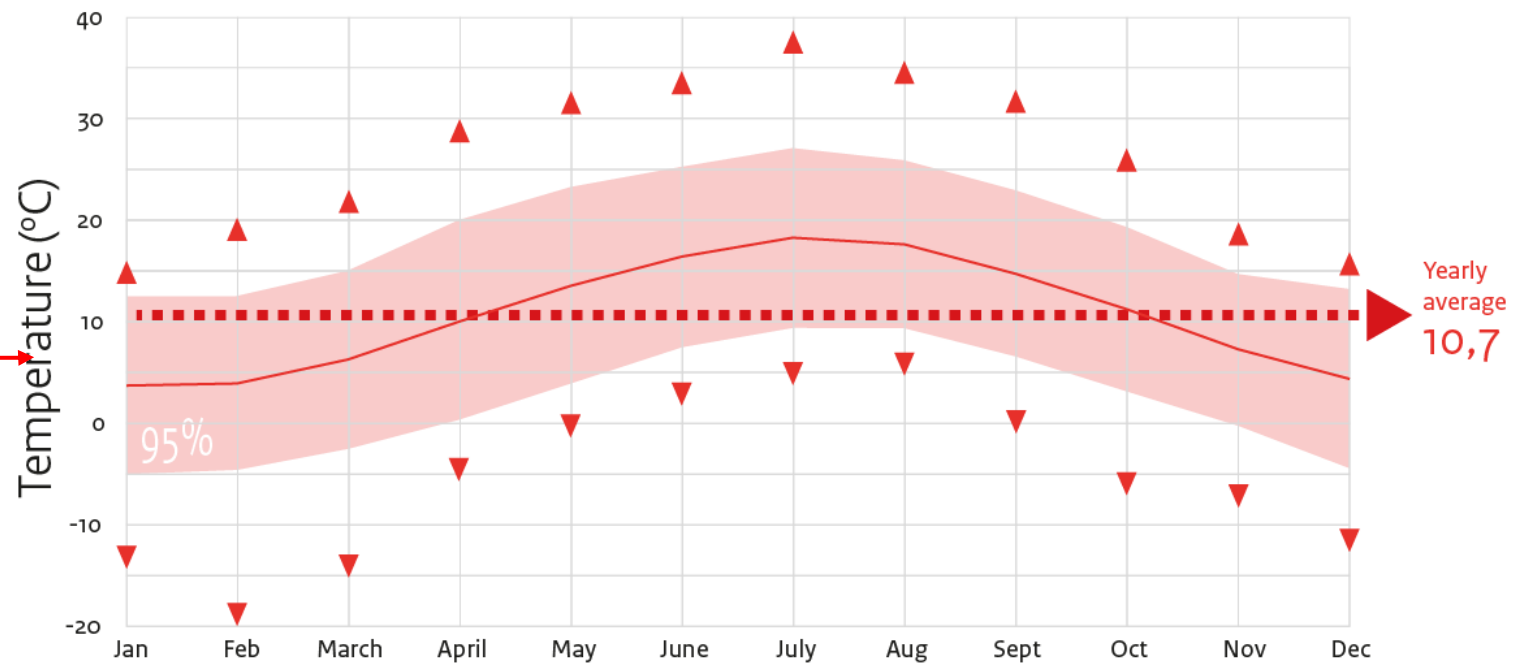

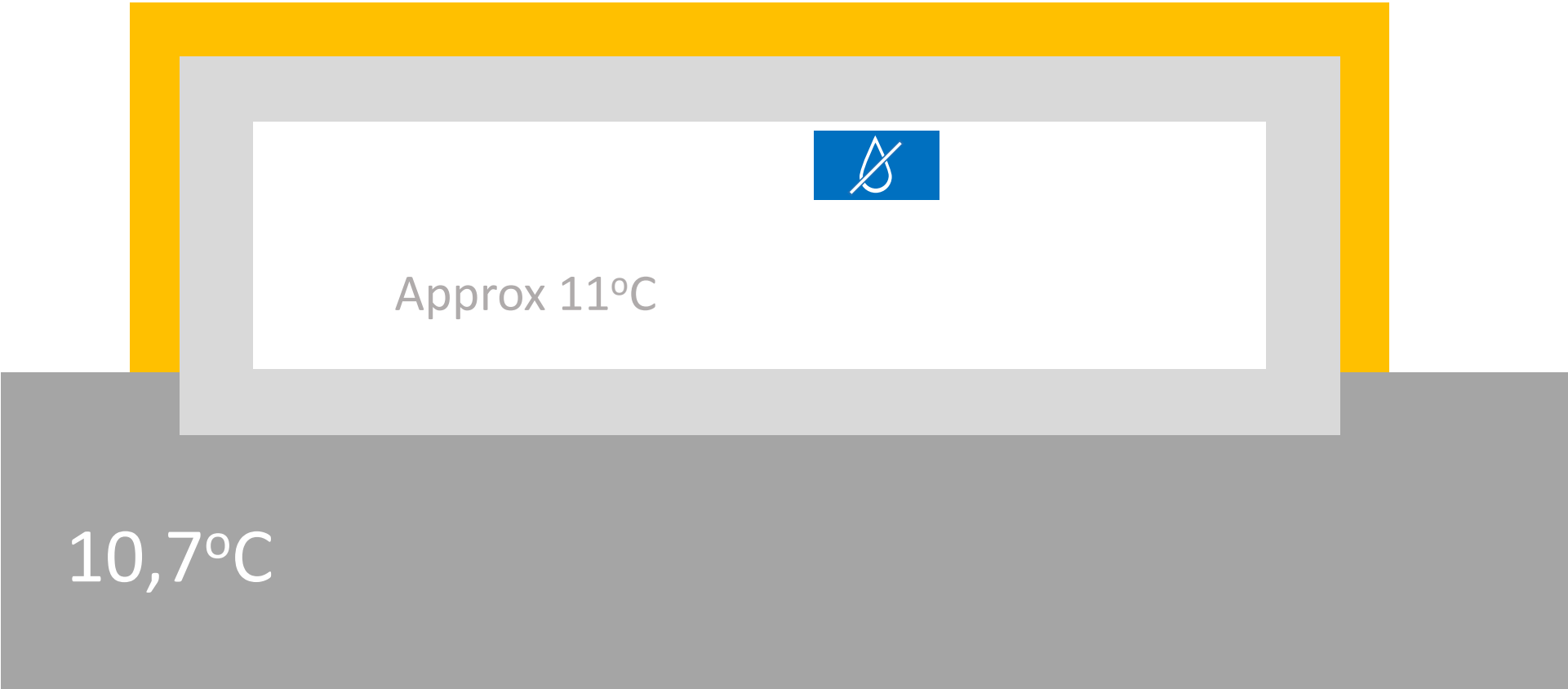

Ventilation & recirculation

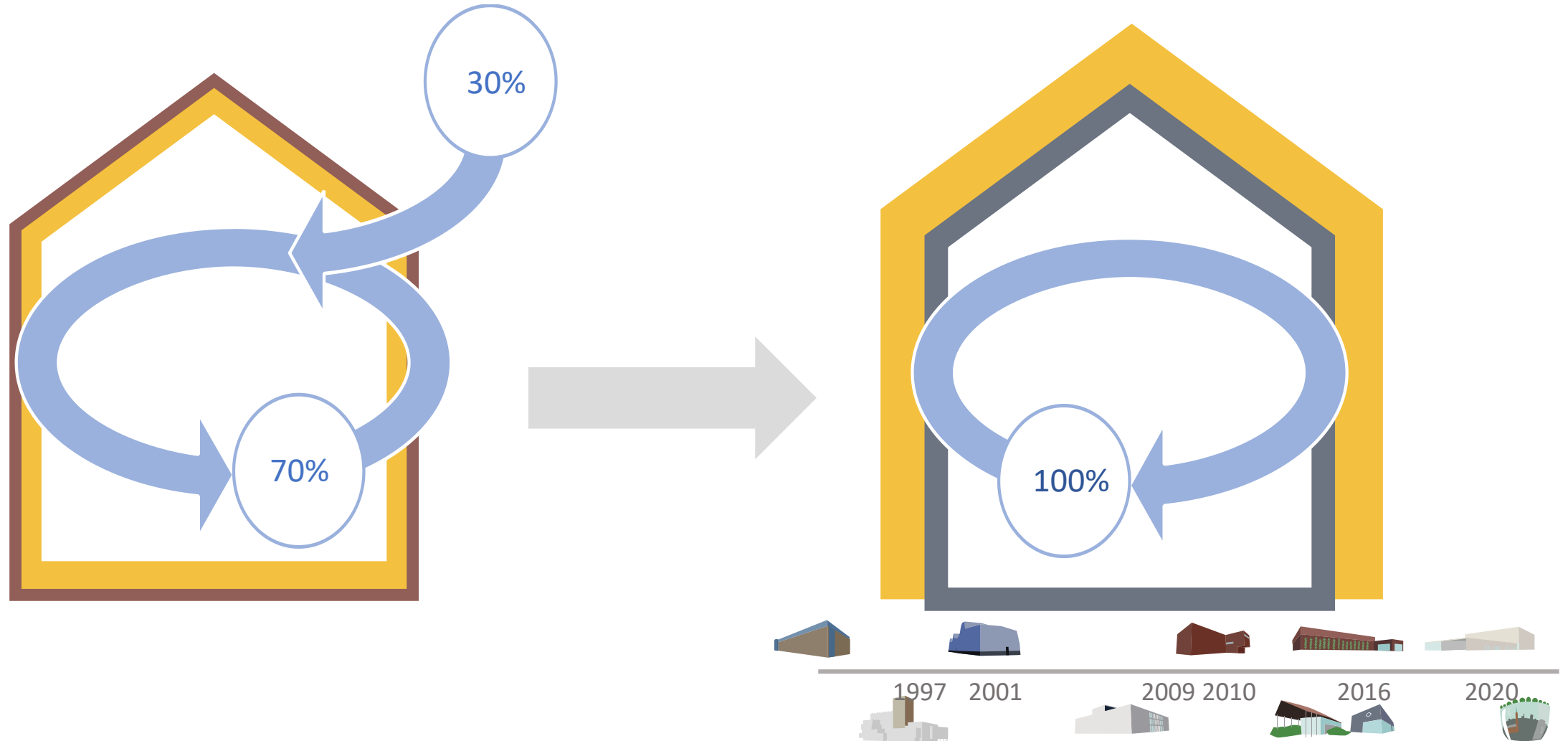

Project proces



Building + Furniture + Collection

Collection + Furniture + Building

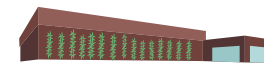
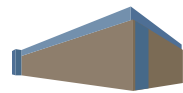

1997

2001

2009

2010

2016

2020



Building layout

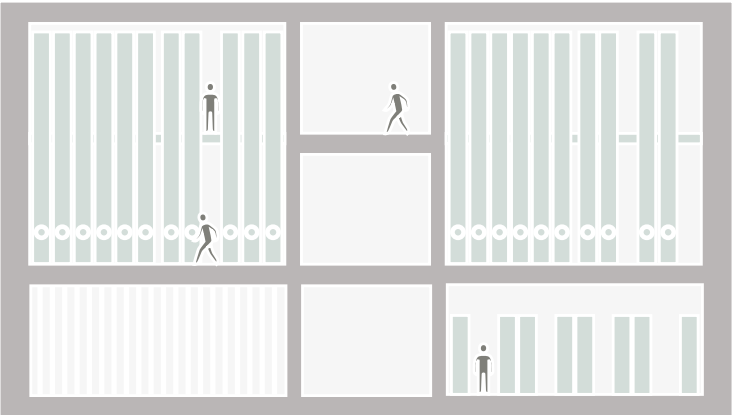

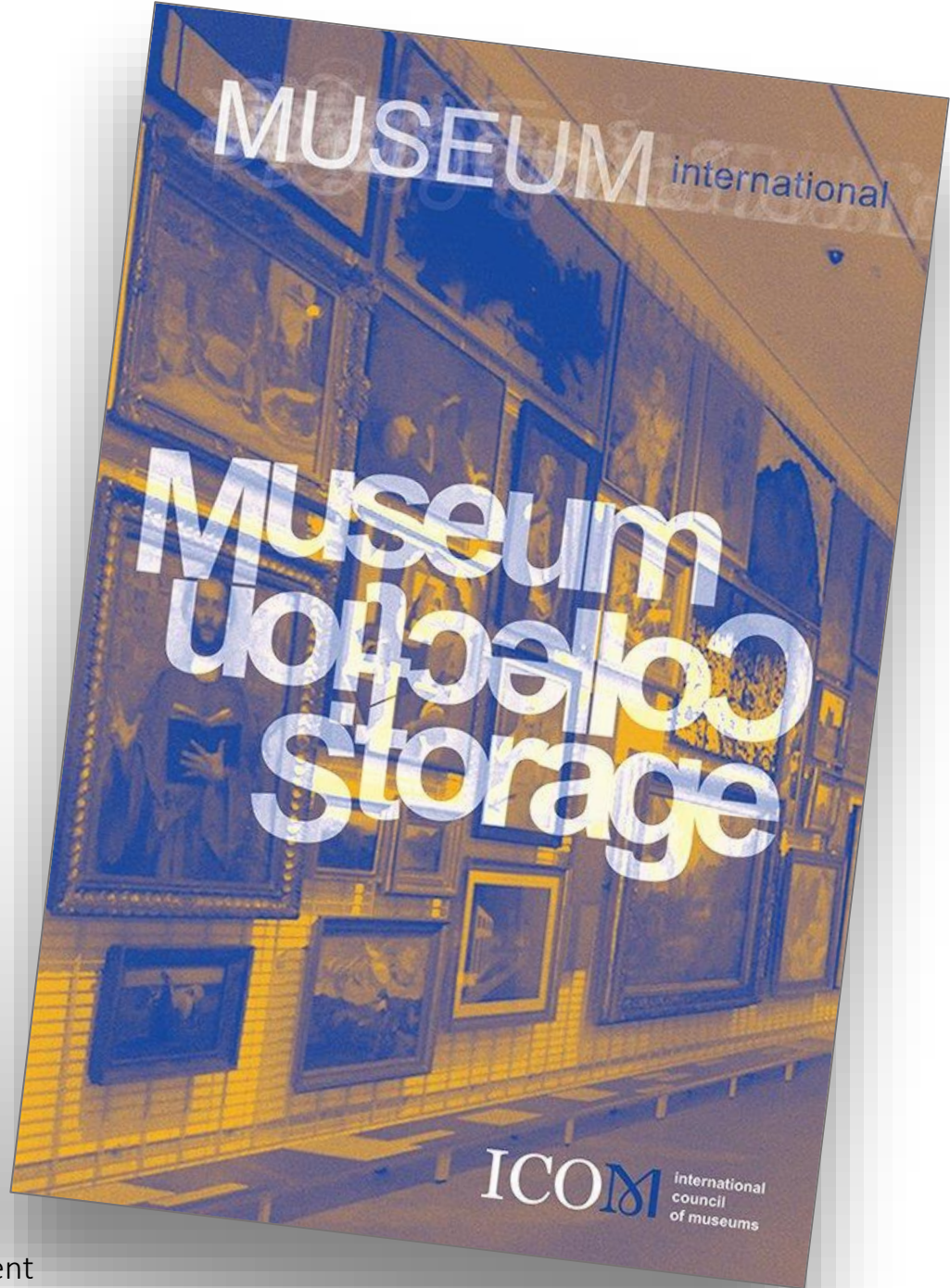

MUSEUM international

Museum storage

ICOM international council of museums



Rijksdienst voor het Cultureel Erfgoed
Ministerie van Onderwijs, Cultuur en
Wetenschap



Gebouwd om
te bewaren

Waar staan we met Erfgoeddepots in Nederland?

<https://www.cultureelerfgoed.nl/publicaties>

Most recent project



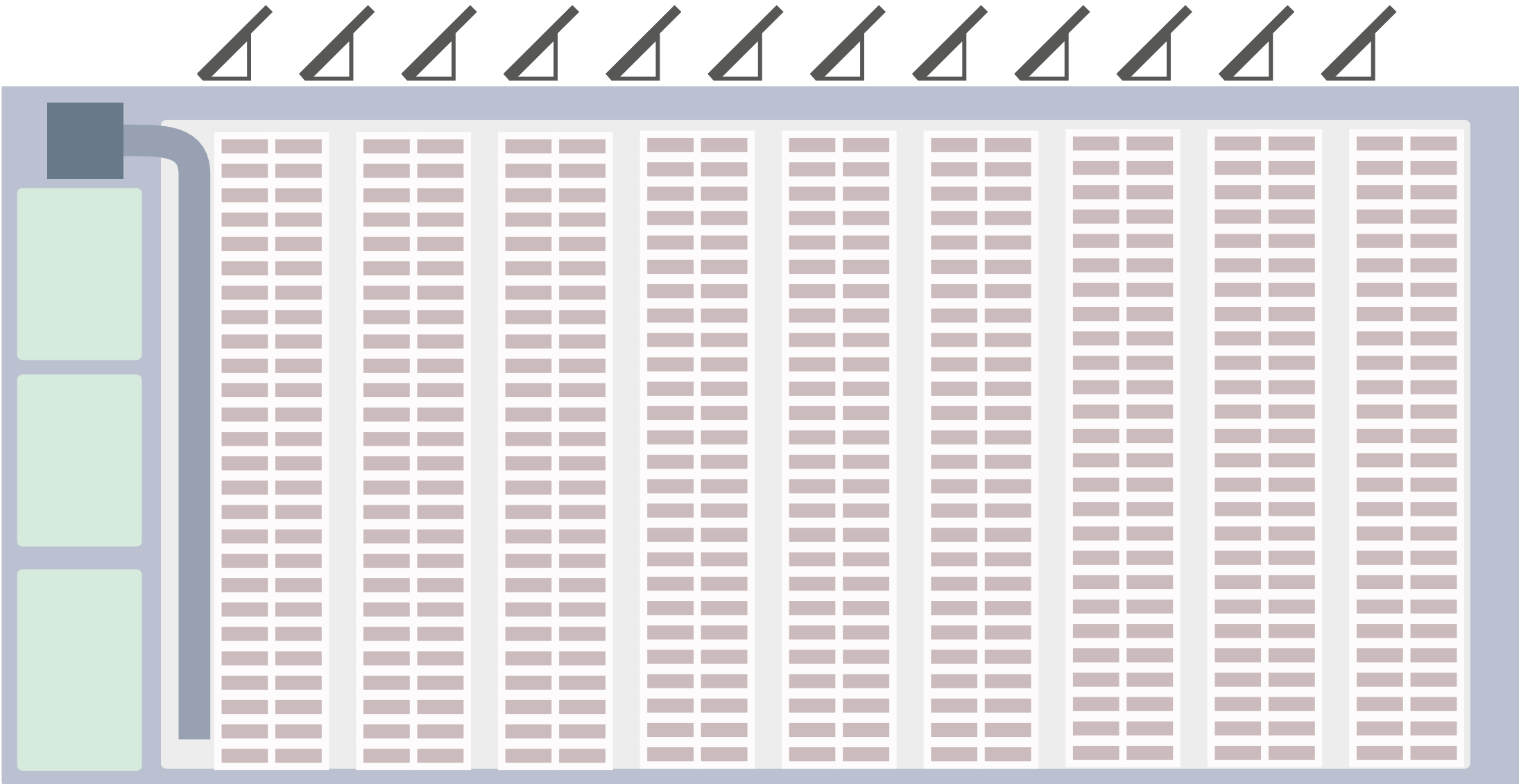

High density storage

Hygric buffer provided by collection

Dry nitrogen used for fire control / dehumidification / circulation

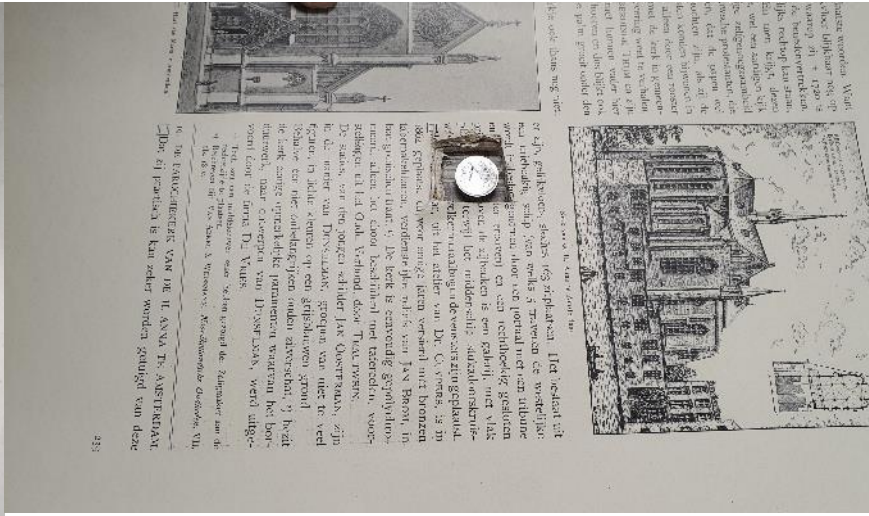



Rijks erfgoedlaboratorium
Rijksdienst voor het Cultureel Erfgoed

Hobbemastraat 22
1071 ZC Amsterdam

06 52 732 102
b.ankersmit@cultureelerfgoed.nl